

Packing List

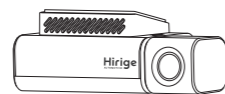

Dash Camera×1



Car Charger×1



Power Cable×1

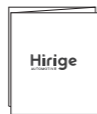

Quick Start Guidex1



Electrostatic Sticker×1

Hirige

AUTOMOTIVE

Quick Start Guide

Dash Camera H10
Version 1.0.0

Camera Introduction

i Cut off the power supply before installing TF card.

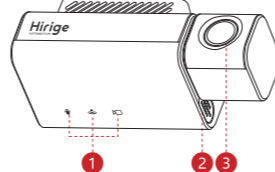

★ LED Indicator:

Recording

Recording stopped

On: Wi-Fi not connected

Flash: Wi-Fi connected

Not recording/TF card not inserted

Recording

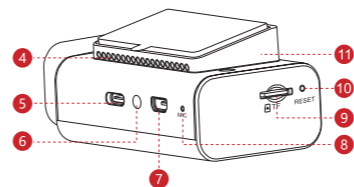

- | | | |
|--------------------|---------------------------------|------------------|
| 1. LED indicator ★ | 5. Power supply interface | 9. TF card slot |
| 2. Speaker | 6. Reversing camera interface ★ | 10. Reset button |
| 3. Lens | 7. Mini USB interface ★ | 11. Bracket |
| 4. Louver | 8. MIC | |

★ Reversing camera interface: Connected to reversing camera (Only supported on upgrade module).

★ Mini USB interface: Reserved. Not supported for now.

Camera Installation

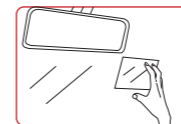

① Wipe the front windshield clean. Stick the electrostatic sticker on the glass and ensure that it is free of bubbles.

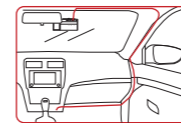

③ Tear off the 3M adhesive on the bracket, paste the dash camera on the electrostatic sticker, and lay cable as shown in the figure.

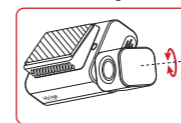

⑤ Adjust the lens to the appropriate monitoring scene. The maximum adjustment angle of the lens is 165°. The installation is completed.

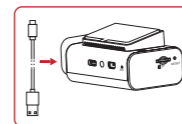

② Insert one end of the power cable into the power supply interface of the dash camera.

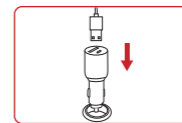

④ Insert the car charger into the cigarette lighter and connect the power cable of the camera.

Operating with App

① Scan the following QR code to download and install the App.



iOS



Android

② Run the App, select and connect Wi-Fi of the camera.

③ After successful connection to the camera, you can set parameters and real-time preview video.

Factory Default Information

Wi-Fi: DH_H10_NT9_XXXXXX

Password: 12345678



Scan the QR code to get multi-language guide.

Functions

Start and shutdown

Connect the dash camera to the vehicle power supply through cigarette lighter. When the vehicle engine starts, the dash camera will start and record. After the engine shuts down, the dash camera shuts down.

Video Recording

The camera supports normal recording and emergency recording. When recording, you can set whether to collect sound or not in App.

Voice Control

The dash camera supports voice control. After the device is turned on, directly say the command to trigger the corresponding function. This function only support English, Japanese and Russian.

Command	Function
Open recording/Turn on recording	Enable audio recording and video contains sound.
Close recording/Turn off recording	Disable audio recording and video do not contain sound.
Take picture	The dash camera will take a picture.

FAQ

If some functions do not work properly or the relevant setting values are changed, try restarting the camera or restoring the factory settings.

Q: The dash camera is frequently powered off?

- A:
- Confirm whether the power cable of the dash camera is connected normally and whether each port is loose.
 - Ensure that the power cable of the dash camera is normal and free from damage.

Q: The dash camera can not be started?

- A:
- Confirm whether the engine is started and whether the power supply is normal.
 - Confirm whether the cigarette lighter is loose.

Q: The dash camera is easy to fall off?

- A:
- Clean the windshield before installation.
 - Check whether 3M adhesive and electrostatic sticker are firmly attached.

Q: The video is blurred?

- A:
- Check whether the lens protective film is removed.
 - Check whether the windshield or camera lens is dirty.

Q: The dash camera cannot record normally?

- A:
- Confirm that the dash camera is started.
 - Confirm whether the TF card is inserted.
 - Confirm whether the TF card is normal: whether the TF card is formatted and whether the service life of the TF card is too long. Replace the TF card.

Q: The mobile phone cannot be connected to the dash camera?

- A:
- Confirm that the correct App has been installed on the mobile phone.
 - Restart the dash camera and App.

Q: The mobile phone cannot play the video?

- A:
- The situation may be related to the player or system of the mobile phone. Please put the TF card into the computer to read and play.

Technical Specification

Parameter	Description
Frame Rate	Single record: 5K Dual record(Upgrade module): 4K+1K
Iris	F1.75
Field of View	143°
Storage	1 TF card port, supports 32 GB-128 GB.
G-sensor	Built in, supports locking video after collision.
ADAS	Support
Wi-Fi	Support
Audio Recording	Support
Power Supply	DC 5V/2A
Rated Power	<3.5W
Operating Temperature	-20°C to 70°C(-4°F to 158°F)
Operating Humidity	95%(MAX)
Size	106.0mm×49.5mm×39.8mm (4.17"×1.95"×1.57")
Weight	≈120g

About the Guide

- This manual is for reference only. The operation of the actual product shall prevail if there is any inconsistency.
- All the designs and software are subject to change without prior written notice.
- All trademarks and registered trademarks mentioned are the properties of their respective owners.
- Please visit our website or contact your local customer service if there is any problem when using the device.
- If there is any uncertainty or controversy, we reserve the right of final explanation.